



CLAUDELANDS

Making an impact



Disney on Ice

**TABLE OF CONTENTS**

THE JEWEL IN OUR CROWN ..... 4

OUR LOCATION ..... 7

CLAUDELANDS ARENA..... 8

ARENA TECHNICAL FACTS.....12

POPULAR ARENA CONFIGURATIONS .....14

YOUR LOCAL CONNECTION .....17

OTHER SERVICES .....20

OTHER H3 VENUES.....23

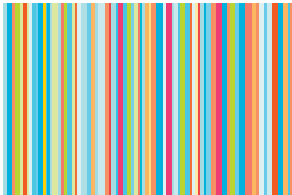



## THE JEWEL IN OUR CROWN

Our award-winning Claudelands Arena is part of the H3 group – home to Hamilton's premier event venues.

Here at H3 we live and breathe events, whether for sharing of ideas and knowledge, or for pure entertainment. We are much more than just venue management. We bring together the very best venues in Hamilton combined with experienced and passionate staff to provide unrivalled service to our clients.

Claudelands, the jewel in our crown, is an award-winning, one-site, multi-zoned event facility ideal for live music, performance, sport, conferencing, meetings, functions and exhibitions.

Its unique, c-shaped arena is the only one of its type in Australasia, bringing its audiences closer to the action and ensuring everyone has the best seat in the house.

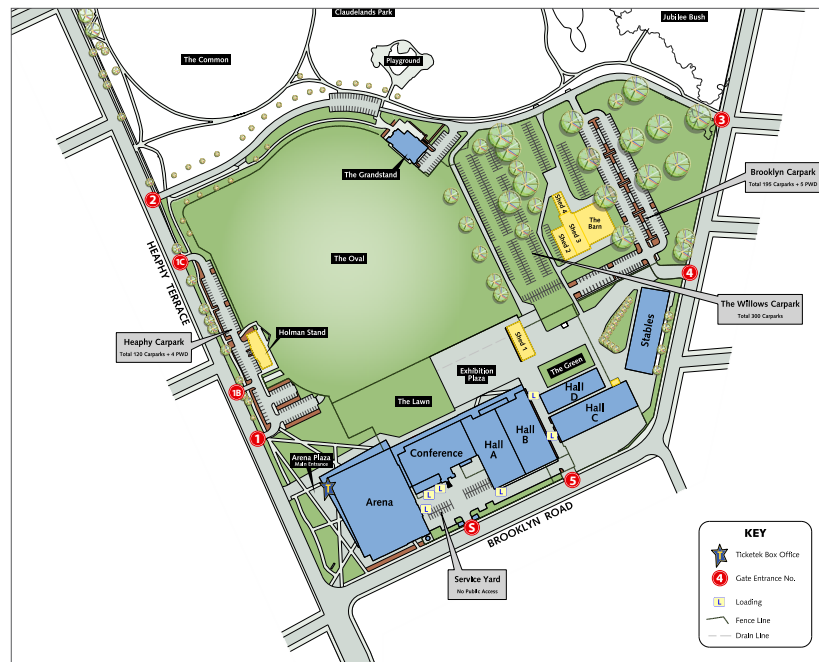





*Claudlands in Hamilton, New Zealand*





*Hamilton, New Zealand*

## OUR LOCATION

Bridging the mighty Waikato, New Zealand's longest river, Hamilton is the country's fourth largest city and the hub of the Waikato region.

A modern, innovative city with a prosperous and diverse economy, Hamilton has a youthful population compared to the likes of Auckland, Tauranga, Christchurch and New Zealand as a whole.

With around half of New Zealand's population within a two-hour drive from Hamilton, the city is an attractive and popular event destination. Survey and ticket data show event-goers frequently travel from throughout the central North Island to attend events at Claudelands.





# CLAUDELANDS ARENA

Claudeland's Arena is a modern solution for live music, entertainment, large banquets, exhibitions and international sport events.

Since its opening in June 2011, the venue has proven itself to be an impressive space that provides a quality guest experience no matter the size or style of event.

Unique in Australasia due to its C-shaped design, Claudeland's Arena boasts 2,200 square metres of scalable space. With both divisional and reduction drapes throughout the arena, we can set these according to your individual requirements.

The venue's clever back-of-house facilities include large band/team rooms, individual dressing rooms and a VIP star suite.

## Arena Upper



## Arena Lower

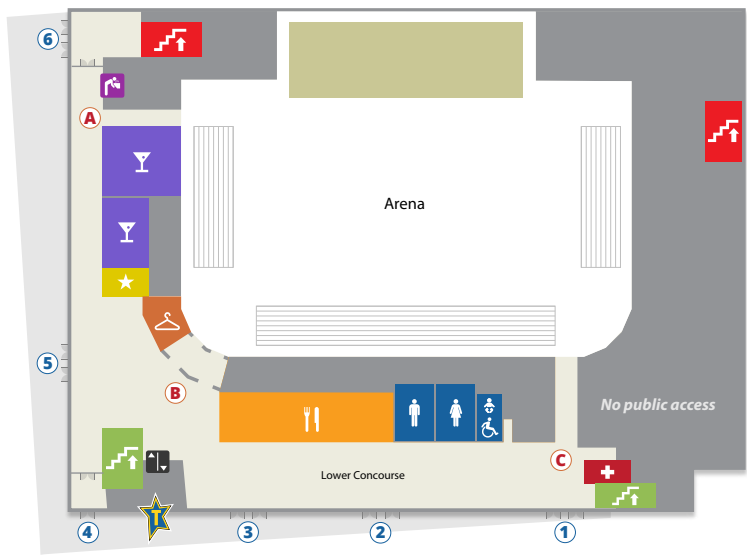

## Legend

- |                       |                   |                               |                                      |                   |
|-----------------------|-------------------|-------------------------------|--------------------------------------|-------------------|
| External door entries | First aid         | Wheelchair accessible toilets | Dining area                          | Drinking fountain |
| Arena door entries    | Ticket box office | Baby changing facilities      | Private lounges (Arena & Executive)  | Coat check        |
| Food & Beverages      | Toilets           | Stairs                        | Private lounges (Oakley & Boardroom) |                   |

Please note configuration of specs may vary depending on the event



Billy Connolly





Harlem Globetrotters





## ARENA CAPACITIES

**6000**

in general admission mode

**5000**

when fully seated

**1400**

for a banquet set-up

**900-2000**

in theatre mode

Whether large or small, every event at Claudelands Arena is assigned a dedicated event coordinator who will work with you to bring your event to life – our experienced team knows our venue inside and out.

Our dedicated operations team will work behind the scenes to ensure the venue build happens seamlessly and according to your requirements and timeframes, while our team of professional event technicians can provide you with world-class arena production service and technical support.

In-house corporate hospitality service Spoilt For Choice can also provide a range of hospitality solutions to suit your needs. We specialise in premium hospitality packages and pride ourselves in delivering a range of VIP enhancements across a wide variety of events.



## ARENA TECHNICAL FACTS

Claudlands Arena offers the following:

- 2,200 square metres of scalable, functional space
- Three-phase power by way of 2 x 400 amp power lock services upstage left next to loading door. 1 x 63 amp cee-form service upstage left. 3 x 63 amp cee-form services outside loading door (broadcast services) (non RCD)
- Grid height of 15m, with total load limit of 36 tonnes evenly distributed across three main beams. Extensive range of motors and truss on site
- An in-house Junkers Portable A4 overlay sprung timber floor suitable for a range of international court events is stored on site
- Full high-speed, fibre internet capability throughout venue
- Load-in via two roller door bays, with the ability to load in two trucks at a time. Case storage is available on site
- In-house PA system comprising 20 JBL PD52 series speakers powered by Crown CTI 2000 amps, in 10 individually adjustable zones. Sound control via DaVinci software, along with hearing aid loops throughout venue
- 83 stage sections with black coated or carpeted surface, standard size 1.2m x 2.4m, with heights from 1200-1800mm in 200mm increments
- Lower retractable seating able to be utilised in several configurations including fully out, half out, front row back, all away or FOH positioning

*\*A copy of the Claudlands Technical Specifications is available on request for further information*







*Riding With The Stars*



# POPULAR ARENA CONFIGURATIONS

FRONT STAGE (CAPACITY: 2000\*)

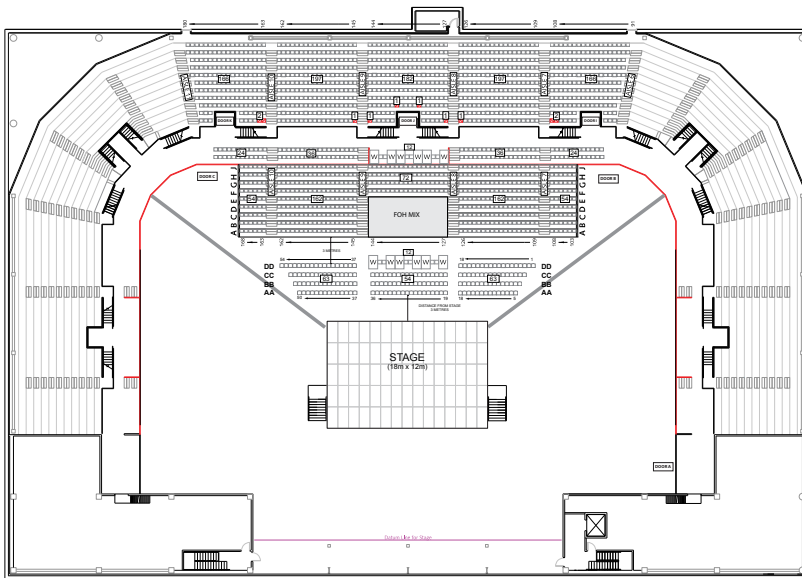

FULL ARENA SEATED (CAPACITY: (5000\*))

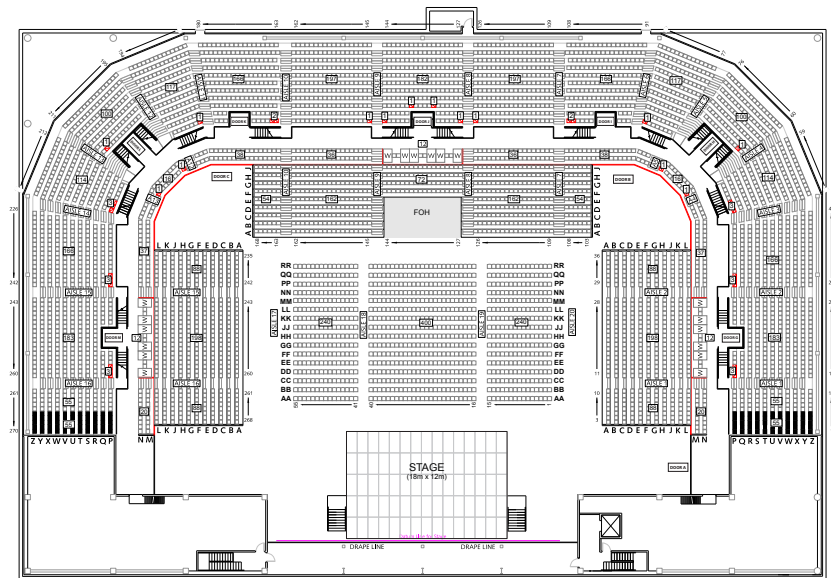

\* Indicative capacities

FULL RETRACTABLES (CAPACITY: 6000\*)

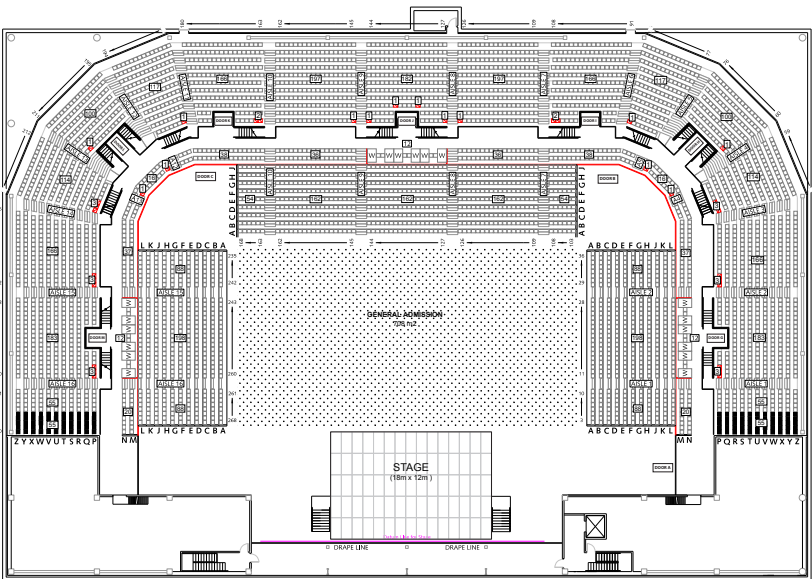

SPORT (CAPACITY: 4300\*)

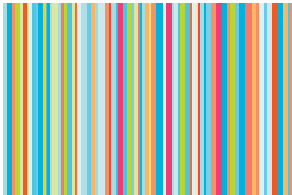
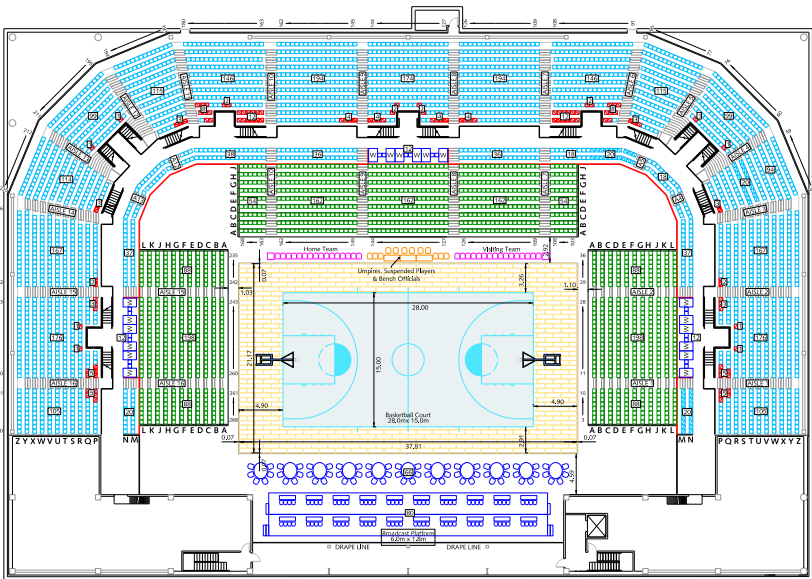





Fans at Six60

## YOUR LOCAL CONNECTION

With strong local knowledge and relationships, and an engaged audience across a range of channels, our in-house marketing team is here to help when it comes to ticketing and promotion of your event.

They can assist you to make the most of Hamilton's free and paid promotional opportunities, and put you in touch with the right local contacts to ensure you get the best exposure possible for your event.

They are also the drivers behind event promotion brand HLive – Hamilton's event hotspot. HLive brings all of Hamilton's hottest events together in one place: from music to comedy and theatre, sport to family entertainment, and more.

With a database of over 60,000 and an ever-increasing online following, HLive serves up all the latest event info to crowds of keen event-goers through its dedicated website, social media channels and e-newsletters.











CLAUDELANDS



## OTHER SERVICES

### H3 TECHNICAL SERVICES

Our dedicated in-house team of professional event technicians can provide you with world-class arena production service and technical support including rigging, audio, lighting and AV. Led by EVANZ's Operational Manager of the Year 2016, our Technical Services team have a wealth of experience working across the globe including alongside the likes of Britney Spears, Justin Timberlake and Christina Aguilera, and are committed to helping bring the 'wow factor' to your event.



### VIDCOM NEW ZEALAND

We offer clients the convenience of on-site AV specialists Vidcom. With a thorough working knowledge of the venue, Vidcom can supply professional and high quality equipment, lighting, sound and communication solutions to suit each unique situation. Vidcom offers a wide range of equipment and technical support to ensure the success of your event, no matter the size.



### MONTANA FOOD AND EVENTS

We are proud to have Montana Food and Events as Claudelands' exclusive catering partner. As one of New Zealand's largest independent catering companies with extensive success and experience in venue catering and large events, Montana can provide innovative solutions to suit any requirement. With a variety of delicious menus the team at Montana will ensure your taste buds are satisfied.



### TICKETEK

Ticketek is Claudelands' exclusive ticketing partner, and operates a Box Office located on site at Claudelands Arena during events. Ticketek, one of the leading ticketing partners to the sports and live entertainment industry, process more than 18 million tickets to over 13,000 events per year.



### SPOILT FOR CHOICE

Our in-house corporate hospitality service Spoilt For Choice can add an extra dimension to your event by providing tailored VIP corporate hospitality packages. A proven performer with strong local client relationships, Spoilt For Choice can work with you to develop and deliver packages which complement and enhance your event to the delight of your guests.





*New Zealand Symphony Orchestra set-up*





*Ricky Martin*

## OTHER H3 VENUES



### FMG STADIUM WAIKATO

Our region's spiritual home of rugby, FMG Stadium Waikato has a crowd capacity of around 25,000. This can be increased by a further 5000 with the addition of temporary seating on the Tristram Street goal line.

This world-class stadium is an ideal venue for everything from rugby and rugby league, to football, action sports such as Nitro Circus, and outdoor concerts.

The stadium's Brian Perry Stand consists of five levels which are home to a range of spaces including corporate lounges, function rooms, a boardroom, management offices, player changing facilities, retail concessions and media facilities.



### SEDDON PARK

Recognised as one of the cricket world's best boutique grounds, Seddon Park is the home of cricket in Hamilton. With a crowd capacity of 10,500, Seddon Park is a regular stop for touring teams competing against New Zealand's BLACKCAPS.

Tree-lined grassy banks around two-thirds of the ground give Seddon Park a distinct 'village green' feel and were noted as one of its striking features by influential cricket magazine *The Cricketer*, which rated it as one of the top 20 cricket venues in the world in 2012.

Seddon Park also has several rooms available for private and business functions.

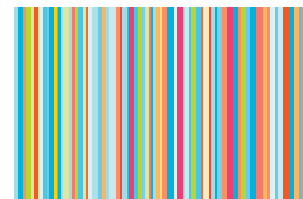



## CLAUDELANDS

Gate 1, Heaphy Terrace, Hamilton 3214  
Private Bag 3010, Hamilton 3240, New Zealand  
**p.** +64 7 929 3000

[www.claudelands.co.nz](http://www.claudelands.co.nz)



[www.h3group.co.nz](http://www.h3group.co.nz)